

**Operating manual for
professional installers
Forced draught oil burner
VECTRON B 30.120/190/230 DUO
VECTRON B 35.320/370 DUO**

elco

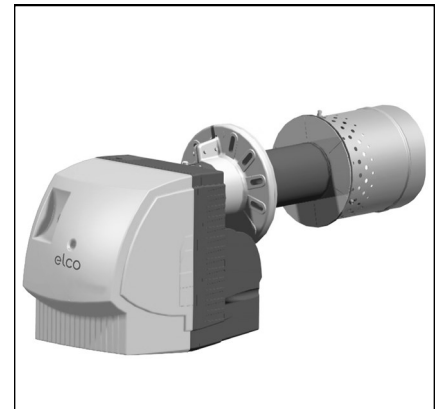
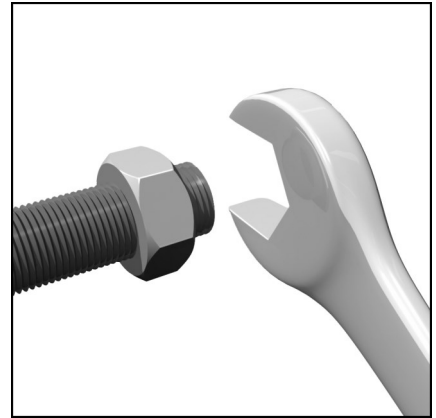

Overview

Table of contents

	Page
Overview	
Table of contents	2
Conformity declaration	3
Safety measures	4
Operator handover Installation maintenance, burner short description Intended use, symbols used	
Dimensions	5
Technical specifications, fields of application	6
Burner overview	7/ 8
Function	
Oil pump	9
Servomotor air regulation, recirculation gap servomotor	10
Automatic burner controller	11
Electrical connection, oil connection	12
Assembly	
Mounting the boiler to the burner	13
Equipment panel service position, push bar adjustment	14
Flame tube mounting	
Oil nozzle selection and installation, ignition electrodes inspection ...	15
Equipment panel installation, nozzle position adjustment	16
Acoustic optimisation	17
Commissioning	
Oil and electrical connections	18
Recommendations for combustion efficiency measurement Guidelines for recirculation gap adjustment	
Recommended settings	19
Burner adjustment 9	
Maintenance	
Brennereinstellung	20
Betriebskontrollen, Endkontrollen, Wartungsvorgang	21
Betriebsstörungen	22
Circuit diagram	
Anzeigen des Feuerungsautomaten	23
Circuit diagram VB30....D	24
Circuit diagram VB35....D	25

Overview

Conformity declaration

Declaration of conformity CE

Declaration of compliance D.R. 17/07/2009 - BE

Manufacturer SPM INNOVATION SAS
2, avenue Josué Heilmann
Z.I. de Vieux-Thann
F - 68800 Vieux-Thann

Issued by See end of notice

We hereby certify that the range of equipment specified below is in accordance with the format stated in the EC declaration of conformity, that it is manufactured and distributed in accordance with the regulations and requirements in european directives and with the regulations and requirements defined in the Royal Decree dated 17/07/2009 :

Type of product Fuel oil burner

Model VECTRON B30(35)E1-2

Applied standards

- Royal Decree dated 17/07/2009
- Standard EN 267
- BImSchV 2010
- 2014/35/EC Low Voltage Directive
- Reference Standard: EN 60.335
- 2014/30/EC Electromagnetic Compatibility Directive
- Reference Standards: EN 55.014 - EN 61000

Inspecting organisation TÜV Rheinland/Berlin-Brandenburg
- OB 266 2015 Z2 - 19/03/2015
- OB 266 2015 T1 - 19/03/2015

Measured values NOx < 100 mg/kWh ; CO < 38 mg/kWh

Date : 01/2017

Signature
Chairman
Mr Philippe WEITZ



Overview

Safety measures, operator handover, installation maintenance, burner short description, intended use, symbols used

Safety measures

- The installation must be carried out in accordance with applicable laws.
- In all cases, applicable safety regulations and accident prevention measures must be observed.
- Burner assembly, commissioning, operation and maintenance (inspection, repair) must be performed by qualified, suitably trained personnel
- The manufacturer alone is qualified to carry out repair work to electrical elements, flame monitoring equipment, and other safety equipment.
- It is forbidden to carry out changes or modifications, that are not specified in this manual. This can cause serious burner malfunctions.
- All works, with the exception of burner adjustment, may be carried out only after disconnecting the power supply.
- We accept no liability for any damages or faults identified, which are attributable to non-observance of these instructions.

 The combustion head and flame tube temperature remains at a high level, even after prolonged burner shut down. Handle with care .

System handover to system operator

- During system handover, the installer will ensure that the operator is made particularly aware of those operations, which the operator himself will be required to carry out (burner fault, decommissioning). He must also clarify for the operator, the operations and modifications that may be carried out by qualified personnel only. He may refer to the "Operating Manual" which is attached to the burner.
- The operator must ensure that works to the burner are carried out by qualified personnel only.
- This manual forms part of the burner. Please store it safely in the boiler room, near to the appliance.

Installation maintenance

To ensure optimal operation of your burner and to avoid operating faults, have the following works carried out by a professional on a yearly basis:

- Combustion head cleaning.
- Oil nozzle replacement.
- Electrodes replacement (where necessary).
- Boiler inspection and cleaning.
- Chimney inspection and cleaning.
- Boiler room fresh air supply inspection and cleaning.

Burner short description

The VECTRON B 30/35-series burners are compact oil burners, the structure and function of which conform to burner standard EN267:

- They are supplied with cabling.
- They are fastened to the boiler by a sliding flange.
- All components are arranged on an equipment panel and easily accessible.
- The equipment panel provides optimal maintenance access.
- The flame is monitored by an infrared detector.
- Ignition takes place via an electronic transformer.

Intended use

The VECTRON B 30/35 series burners are intended for firing of hot water boilers for heating buildings and/or domestic hot water.

For any other use, industrial processes, or specific applications, please contact us.

Fuel: European quality heating oil and low-sulphur heating oil (max. viscosity 6 mm²/s at 20 C).

In order to guarantee environmentally friendly operation, ensure optimum compatibility of the burner/boiler/flue gas design configuration. The flue gas system installation and design must be carried out in accordance with applicable guidelines and laws.

Symbols used

 Caution danger!
Risk of damage to persons and equipment. For the safety of persons and equipment, these instructions must be strictly observed.

 Note. These instructions will assist you in manoeuvring the burner

 Assembly phase

 Key figures

Overview

Dimensions

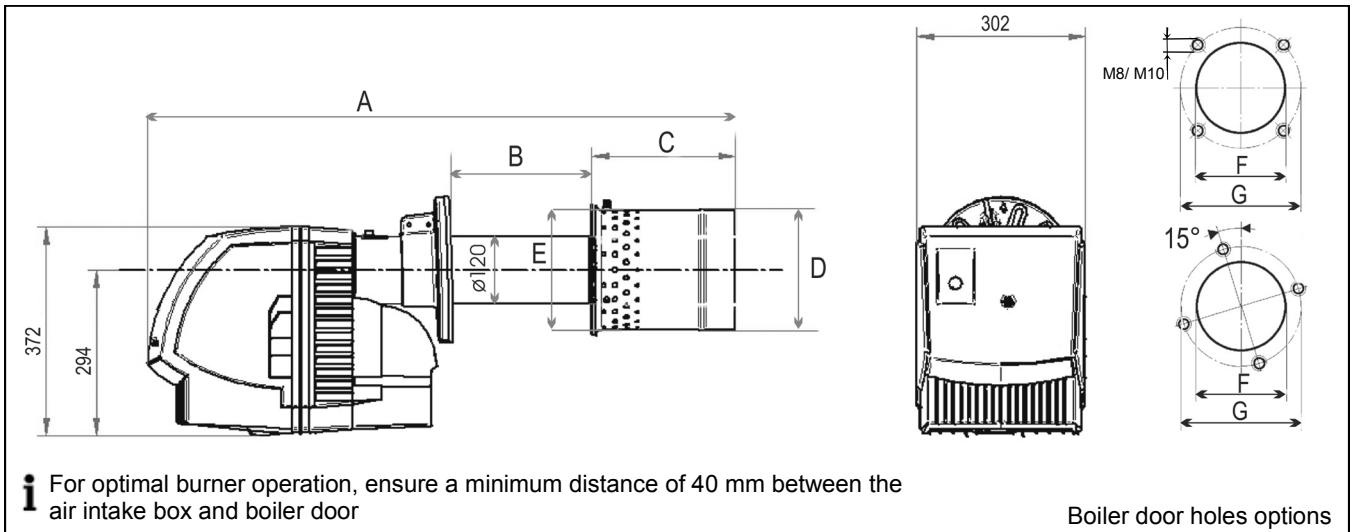

Burner type	Dimensions [mm]						
	A	B	C	ØD	ØE	ØF	ØG
VB30.120D	824	max.145	180	150	175	Min.130	170 →220
VB30.190D	856	max.145	210	160	190	Min.130	170 →220
VB30.230D	866	max. 145	220	160	212	Min.130	170 →220
VB35.320D	1010	max.260	220	180	212	Min.130	170 →220
VB35.370D	1048	max.260	260	210	230	Min.130	170 →220

i Allow a clearance of at least 1.00m behind the burner, so as to be able to move the burner into the service position

Burner type	Dimensions [mm]				
	ØA	ØB	ØC	ØD	ØE
VB30.120D	14	68	9.5	6	175
VB30.190D	15	68	12	8	190
VB30.230D	16	68	14,5	9,5	212
VB35.320D	16	72	14.5	11	212
VB35.370D	16	72	16	11	230

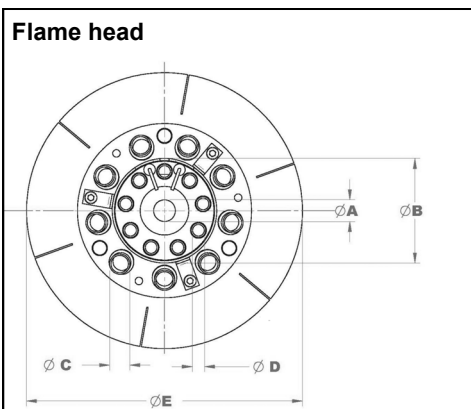

Overview

Technical specifications, fields of application

Technical Specifications					
Burner	VB30.120D	VB30.190D	VB30.230D	VB35.320D	VB35.370D
VKF approval no.	26125	26125	26125	26125	26125
Operation	2-stage	2-stage	2-stage	2-stage	2-stage
Performance range (EN 267) [kW] ^{(1)*}	(48) 76 - 117	(68) 110 - 190	(131) 184 - 231	(120) 184 - 324	(138) 214 - 367
Oil flow [kg/h] ^{(2)*}	(4.0) 6.4 - 9.9	(5.7) 9.3 - 16,0	(11.0) 15.5 - 19.5	(10.1) 15.5 - 27.3	(11.6) 18.0 - 31.0
Total input power [W]	360	550	550	830	830
Rated power motor (230V / 50Hz)	260 W** 2850 R/min	380 W** 2850 R/min	380 W** 2850 R/min	650 W** 2850 R/min	650 W** 2850 R/min
Noise level at 1 m [dBA]	68	69	69	72	72
Net weight [kg]	26	26	26	34	34
Gross weight [kg]	29	29	29	37	37
Nozzle marking (outer)	1	2	3	3	4
Nozzle marking (inner)	1	2	3	1	1

(1) Output at a height of 500m over NN (Normal Null) and a temperature of 20°C. Fuel heating value: Hi = 11.86 kWh/kg.

(2) Fuel: Heating oil (max. viscosity 6 mm²/s at 20°C).

* (Min. stage 1) min. stage 2 - max stage 2.

** Separate burner motor power supply (see electrical wiring diagram).

Performance curve according to standard EN 267

Burner output at a height of 500 m and a temperature of 20°C.

Performance loss at greater heights 1.45% per 100m. Fuel heating value: Hi = 11.86 kWh/kg.

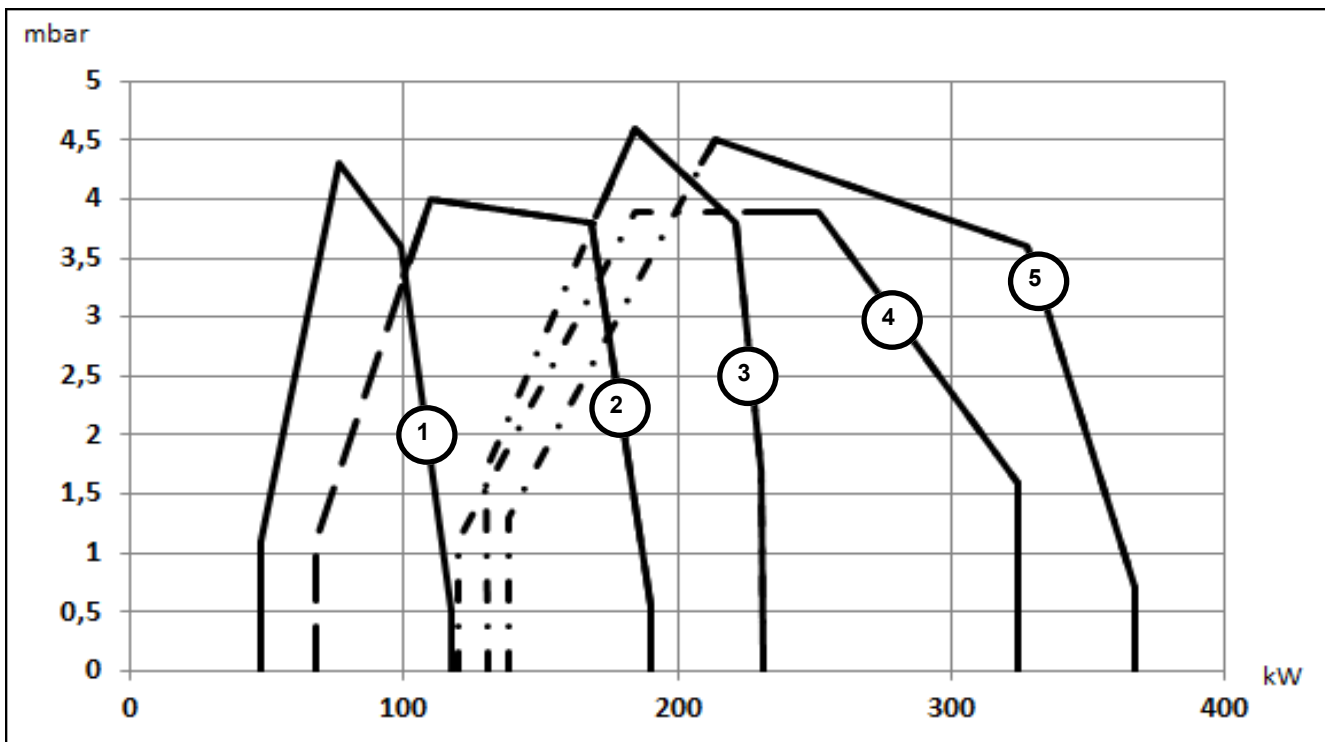

① VB30.120D ② VB30.190D ③ VB30.230D ④ VB35.320D ⑤ VB35.370D

Overview

Burner overview VB30.120D / 190D / 230D

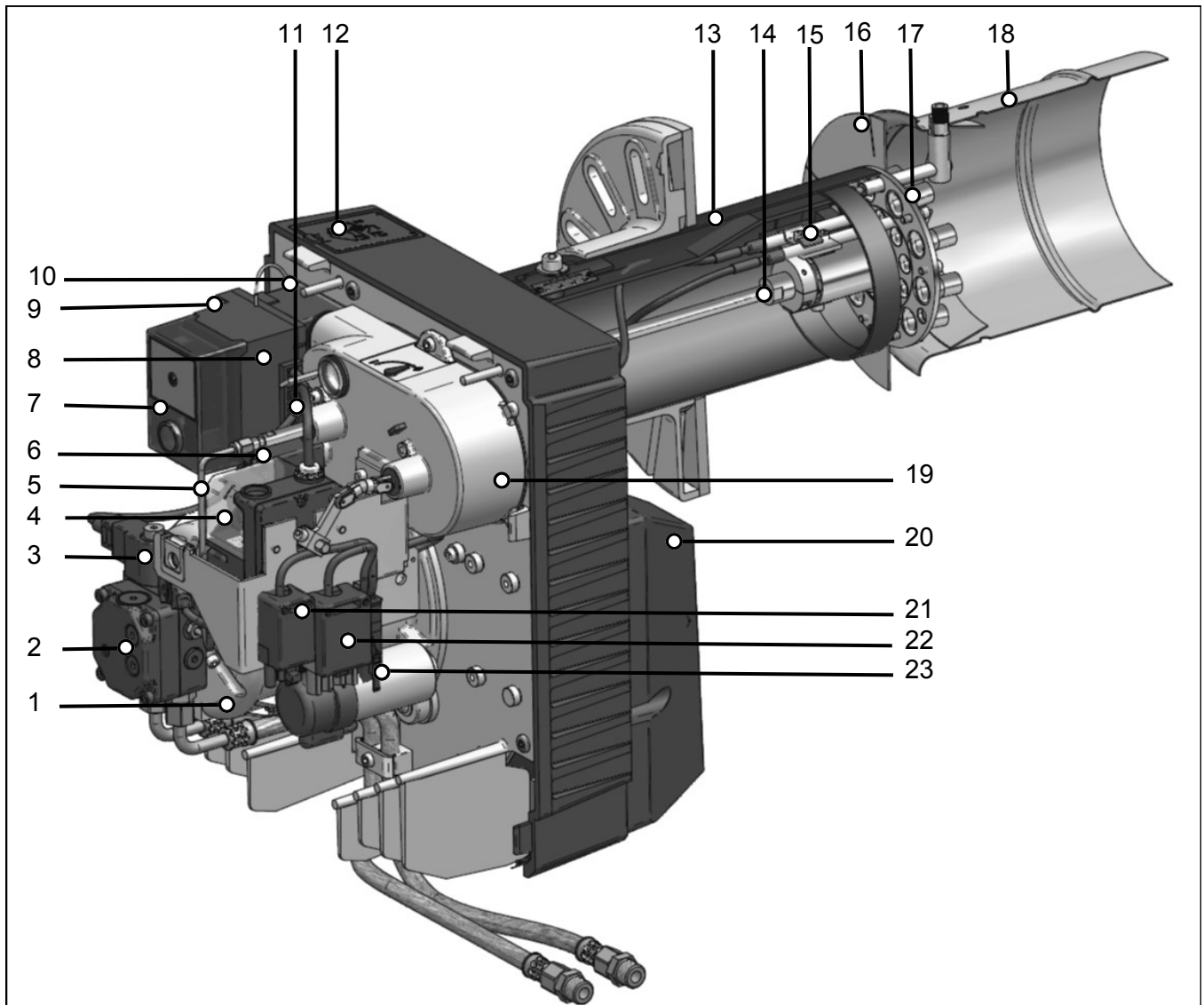

- 1 Blower and pump motor
- 2 Oil pump
- 3 Solenoid valves
- 4 Air regulation servomotor
- 5 Heating oil supply tube
- 6 Flame monitor
- 7 Automatic burner control
- 8 Automatic burner controller socket with boiler connection (covered)
- 9 Heat demand indicator (green LED)

- 10 Ignition transformer
- 11 Nozzle position adjustment screws
- 12 Recirculation gap servomotor
- 13 Burner tube
- 14 Nozzle linkage
- 15 Ignition electrodes

- 19 Air housing
- 20 Air intake box
- 21 Water conservation valve
- 22 Boiler connection (thermostat)
- 23 Remote unlock

Overview

Burner overview VB35.320D / 370D

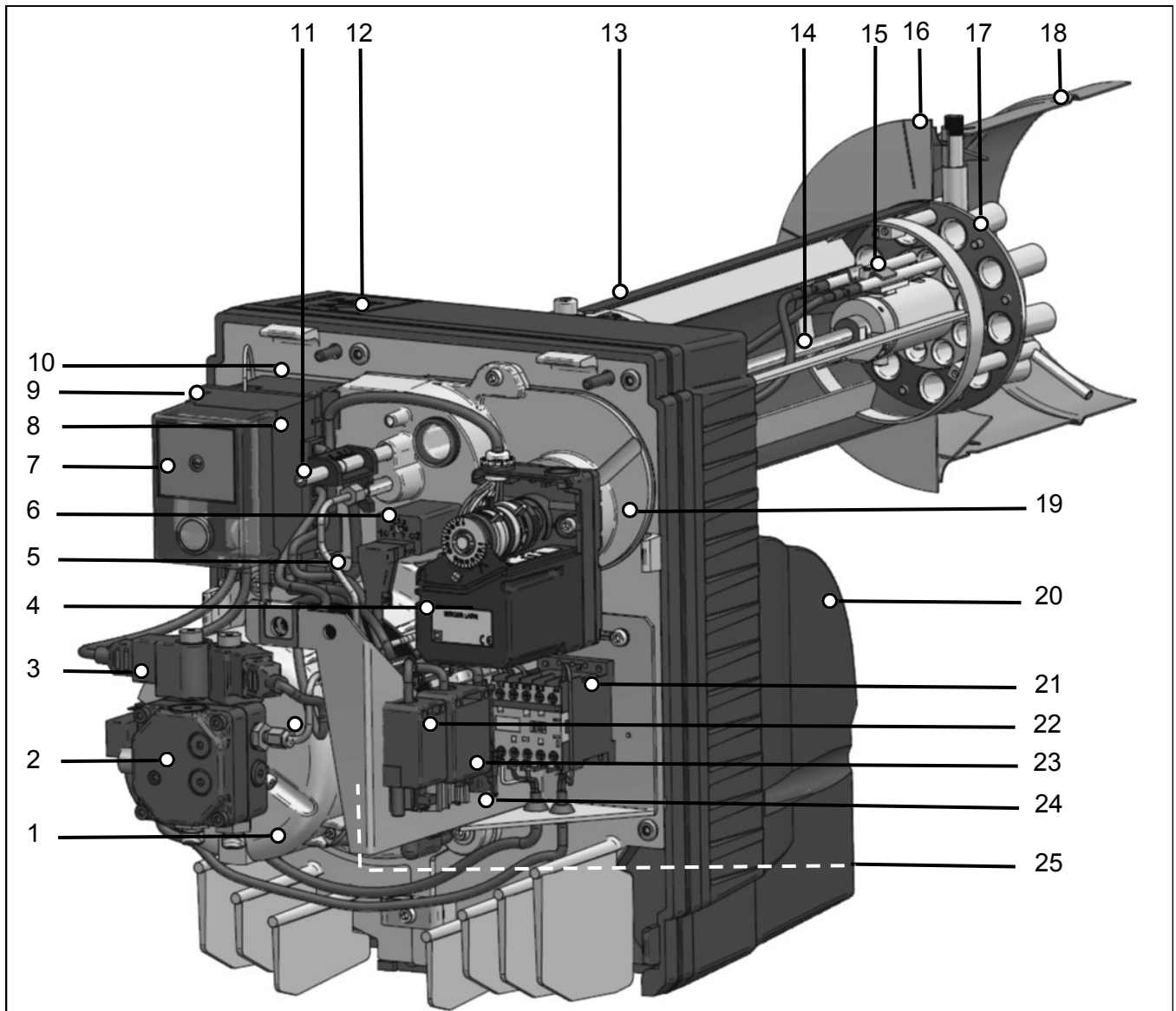

- 1 Blower and pump motor
- 2 Oil pump
- 3 Solenoid valves
- 4 Air regulation servomotor
- 5 Heating oil supply tube
- 6 Flame monitor
- 7 Automatic burner control
- 8 Automatic burner controller socket with boiler connection (covered)
- 9 Heat demand indicator (green LED)

- 10 Ignition transformer
- 11 Nozzle position adjustment screws
- 12 Recirculation gap servomotor
- 13 Burner tube
- 14 Nozzle linkage
- 15 Ignition electrodes
- 16 Flame tube plate
- 17 Flame head (nozzle plate)
- 18 Flame tube

- 19 Air housing
- 20 Air intake box
- 21 Motor contactor
- 22 Water conservation valve
- 23 Boiler connection (thermostat)
- 24 Remote unlock
- 25 Separate blower motor power supply

Function

Oil pump

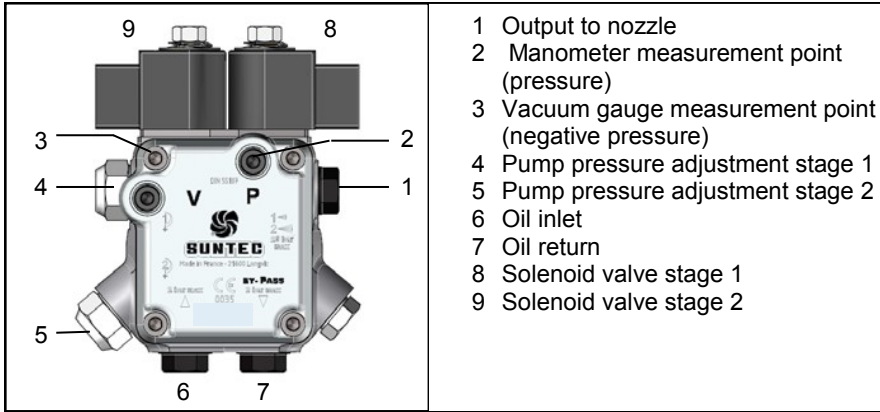

Oil pump

The pump is a self-priming, clockwise-rotating gear pump (as viewed from the shaft side):

- It integrates a supply filter and an oil pressure regulator.
- The oil pump is connected to a vent filter via a two-pipe system.

i Vent the oil pump carefully during commissioning .

Oil burner	VB30...D
Oil pump	SUNTEC AT2 V 45
Ambient temperature (under the hood)	80°C
Pressure range stage 1	8-15 bar
Pressure range stage 2	12 - 25 bar
Max. negative pressure	0.45 bar
Max. allowable supply pressure	2 bar
Max. allowable return pressure	2 bar
Pump intake flow at 10 bar	48 l/h
Pump intake flow at 25 bar	28 l/h

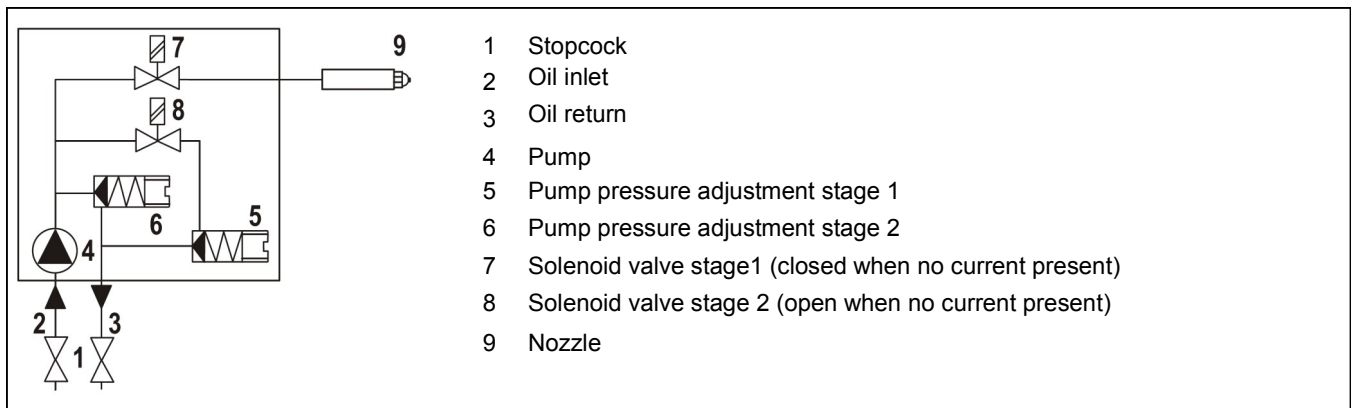

Function

Air regulation servomotor Recirculation gap servomotor

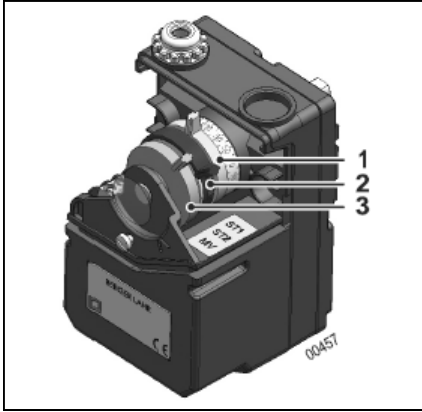

**Air regulation servomotor
VB30.120D / VB30.190D / VB30.230D**

- 1 Vent ST1:**
Air volume adjustment stage 1
- 2 Vent ST2:**
Air volume adjustment stage 2
- 3 Vent MV:**
Solenoid valve opening stage 2

- i** • The servomotor controls opening of the air damper. To adjust air damper opening, use vents ST1 for partial load and ST2 for full load.
- Adjust the MV vent between ST1 and ST2 (5° below ST2).

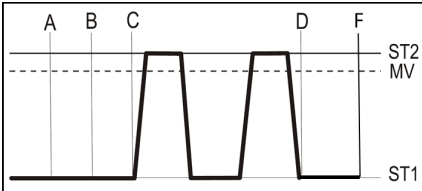

- | | | | |
|-----|------------------|-----|---------------|
| A | Burner start-up | C-D | Controller |
| A-B | Pre-aeration | D | Burner stop |
| B-C | Ignition | F | Post-aeration |
| C | Start-up stage 2 | | |



**Air regulation servomotor
VB35.320D / VB35.370D**

- 1 Vent MV:**
Solenoid valve opening stage 2
- 2 Vent ST0:**
Exclusion of air
- 3 Vent ST2:**
Air volume adjustment stage 2
- 4 Vent ST1:**
Air volume adjustment stage 1

- i** • The servomotor controls opening of the air damper. To adjust air damper opening, use vents ST1 for partial load and ST2 for full load.
- Adjust vent ST0 to 0°.
- Adjust the MV vent between ST1 and ST2 (5° below ST2).
- Use the screws located on the vent for fine-tuning.

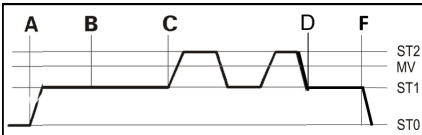

- | | | | |
|-----|------------------|-----|---------------|
| A | Burner start-up | C-D | Controller |
| A-B | Pre-aeration | D | Burner stop |
| B-C | Ignition | F | Post-aeration |
| C | Start-up stage 2 | | |

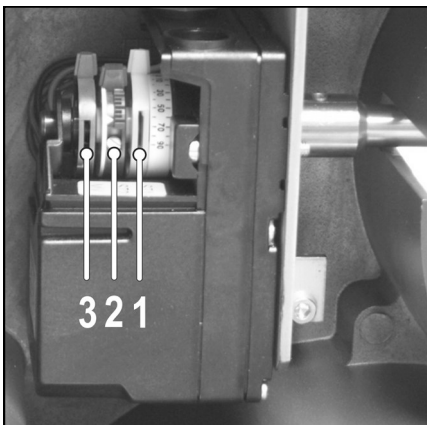

Recirculation gap servomotor

The servomotor located in the upper left hand part of the burner can ensure optimal recirculation gap adjustment. Access is via the lid on top of the burner.

- 1 Vent I**
Flame tube position at start-up
- 2 Vent II**
Flame tube position during operation
- 3 Vent III**
Releases the 2 burner stages

- i** Adjust vent III to between I and II (5° below II)

Function

Automatic burner controller

Automatic burner controller socket



The socket is a safety device. It is forbidden to open it.

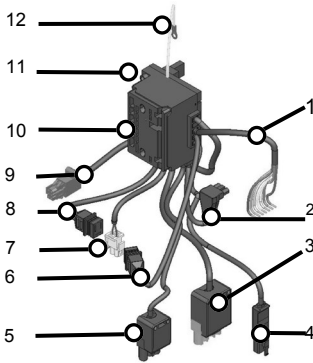

- 1 Air regulation servomotor connection
- 2 Flame monitor connection
- 3 Burner to boiler connection (4-pin plug connection)
- 4 Remote unlock
- 5 Water conservation valve connection
- 6 Solenoid valve connection stage 1
- 7 Motor connection. Separate supply
- 8 Solenoid valve connection stage 2
- 9 Recirculation gap servomotor connection
- 10 Burner to boiler connection (7-pin plug connection)
- 11 Green LED: Illuminated = burner switched on, off = burner switched off
- 12 Equipment panel grounding

Automatic burner controller DKO 992 - N Operating cycle

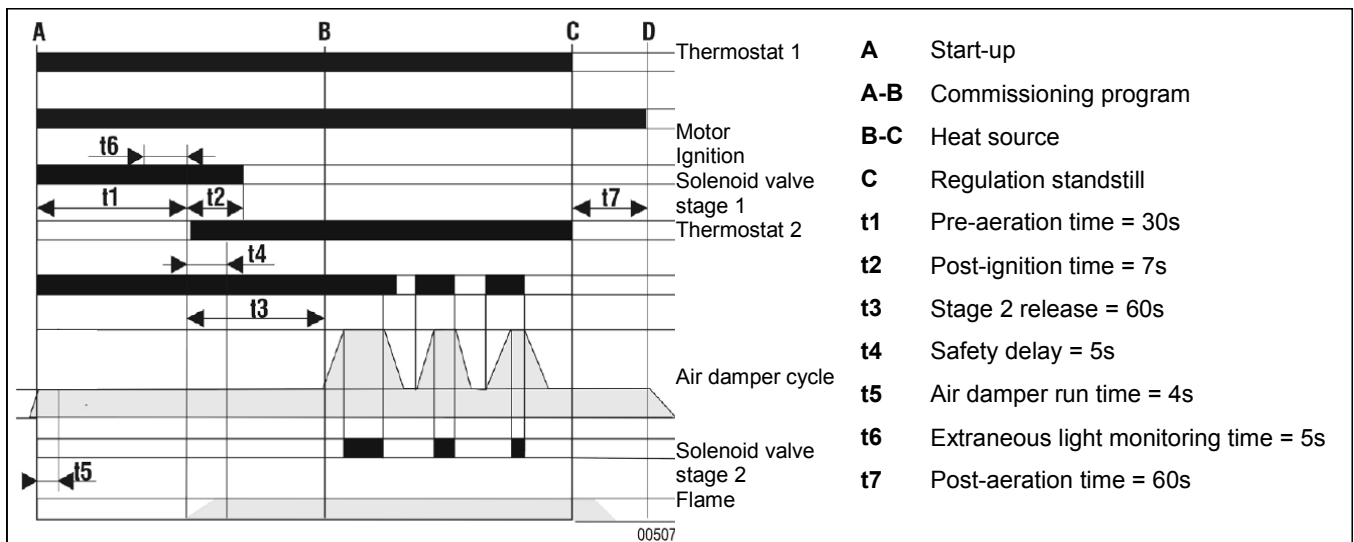

The automatic burner controller may be connected to the socket or disconnected from the socket, only when the master power switch of the heating system is switched off. The automatic burner controller is a safety device and must not be opened.

Operation and fault displays

The automatic burner controller is controlled by a microprocessor.

During normal burner operation, a blink signal indicating burner operation status is displayed every 5 seconds via the light-emitting diode (LED). Between blink signals, the LED is off.

If a fault occurs, a blink signal is displayed every 10 seconds to indicate the error. Between blink signals, the LED is continually on.

A table showing the various blink signals can be found in the "Maintenance" chapter.

Further information can be read via optional accessory communication software.

Function

Electrical connection Oil connection

Electrical connection

 A manually operated circuit breaking device must be used to isolate the system during maintenance, cleaning and repair work. It must simultaneously disconnect all ungrounded lines from the mains supply. This circuit breaker is not supplied. The burner is supplied ready for operation with a single-phase mains voltage of 230 V - 50 Hz. This burner does not require a thermal relay. For the separate power supply, a 10A fuse is required.

 Before carrying out any operation on the burner, it must be disconnected from the mains. The installation and connections must be carried out in accordance with applicable standards. Ensure that the grounding is correct.

 The connecting cables are equipped with standard DIN 4791 connectors.

Connecting a water conservation valve

The burner is equipped with a connector for connecting a water conservation valve, in the heating oil supply between burner and tank.
(See applicable legislation).

 Adhere to electrical wiring diagram.

Connecting a remote unlock

The burner is equipped with a plug for connection of a remote unlock.

 Adhere to electrical wiring diagram.

Oil connection

The burner is supplied for heating oil connection in the two-pipe system, between the oil pump and a vent filter. The use of a single-pipe system between the filter and the pump is not recommended.

To avoid contamination of the nozzle, a filter (mesh size 80µm to 150µm) must be installed in the heating oil inlet.

It is recommended that you install a single-line system between the tank and vent filter.

Heating oil supply is to be carried out in accordance with applicable standards.

It is important to ensure that supply pressure loss is low (elbow joints, dimensioning, etc.).

 We recommend the use of a combination fuel oil filter—deaerator.

Assembly

Mounting the boiler to the burner

- ❶ Mount seal and sliding flange at mounting position **(A)** on the boiler door.
- ❷ Tighten lower screws, leave upper screws loose.
- ❸ Spread burner flange by tightening screw **(B)**.
- ❹ Loosen flame tube plate fastening screws and spacer on combustion head. Remove the flame tube plate with spacer.
- ❺ Remove equipment panel from housing (to do this, see service position on page 14). Carefully put the equipment panel to one side (do not hang in the housing).
- ❻ Separate the spherical head of the push bar from the servomotor recirculation gap shaft.
- ❼ Slide the push bar forward and turn the 3 retaining bolts on the flame tube inward and fasten.
- ❽ Slide the burner with burner tube into the burner flange.
- ❾ Seal any gap between the burner tube and boiler door insulation with fireproof insulating material.
- ❿ Apply heat resistant grease to the flame tube plate fastening screws and the intermediary ring, and mount both parts.
- ⓫ Position the burner in such a way, that the flame tube plate rests on the boiler door insulation.
- ⓬ Loosen screw **(B)** and tighten the top fastening screws on the burner flange.
- ⓭ Continue assembly with push bar adjustment and flame tube mounting (page 14).

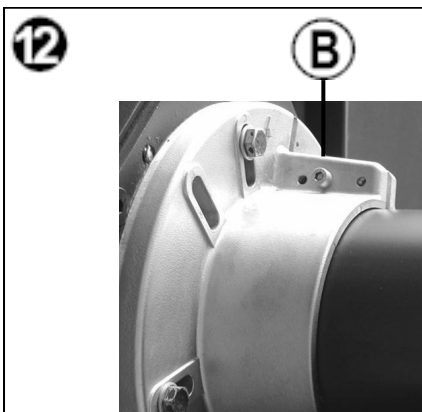
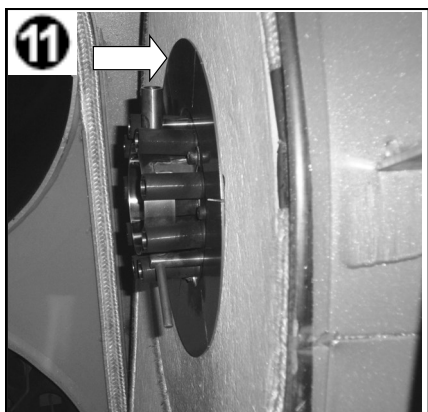
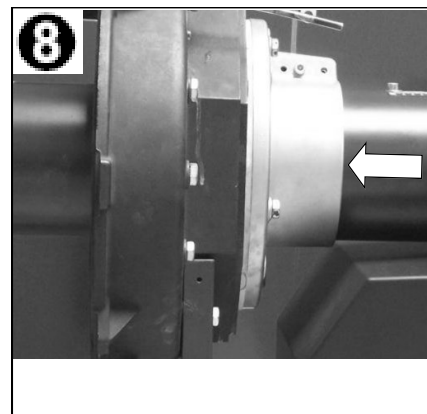
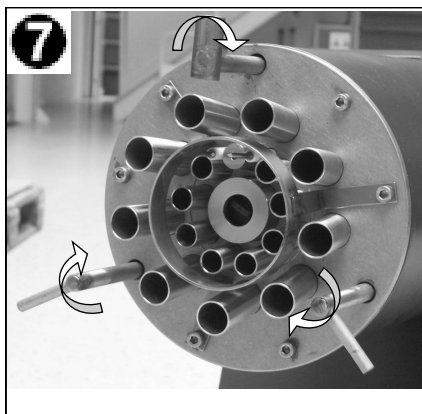
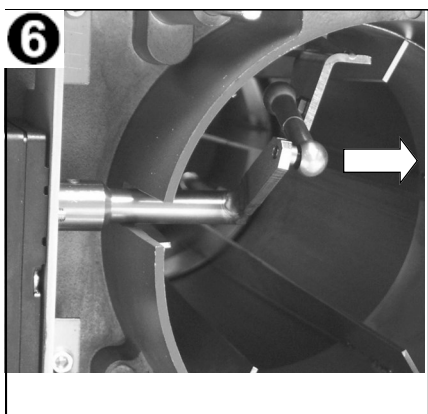
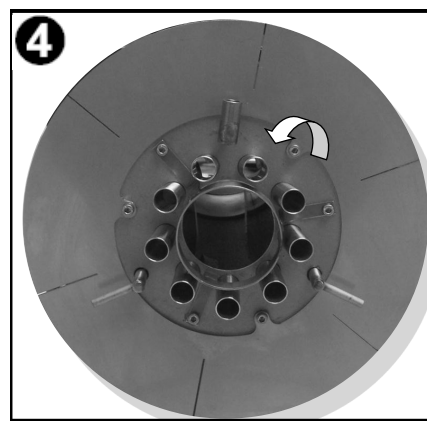
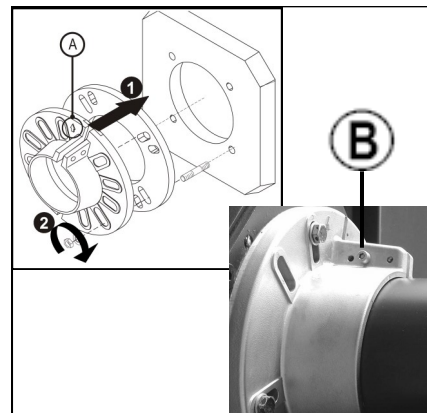

Assembly

Equipment panel service position Push bar adjustment Flame tube mounting

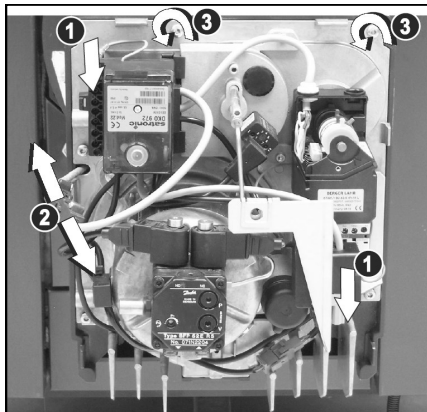

Equipment panel service position

- ❶ Disconnect all burner electrical connections (4-/7-pin from boiler as well as external motor power supply) from the burner.
- ❷ Disconnect the red plug for the recirculation gap servomotor.
- ❸ Unscrew the 5 quick lock screws.
- ❹ Remove the burner components plate from the housing.

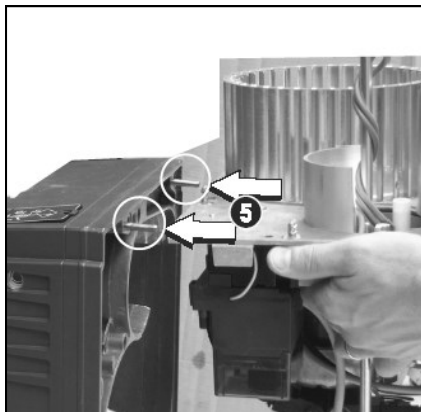

- ❺ 5. Place the equipment panel on the burner housing bolts.

i Avoid any mechanical strain on the blower wheel. Under no circumstances must the blower wheel be used for storage. This could cause bending.

Recirculation gap effect

The proportion of recirculation gas depends on the recirculation gap. This exerts a direct influence on the NO_x level. If the recirculation gap is large, the NO_x content is low. As a result, however, flame stability deteriorates. The recirculation gap must be adjusted, so that the lowest possible NO_x levels are achieved, with a stable flame.

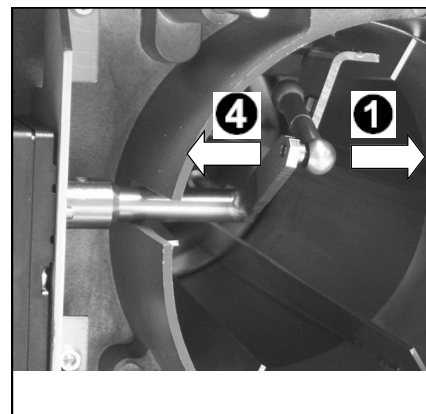
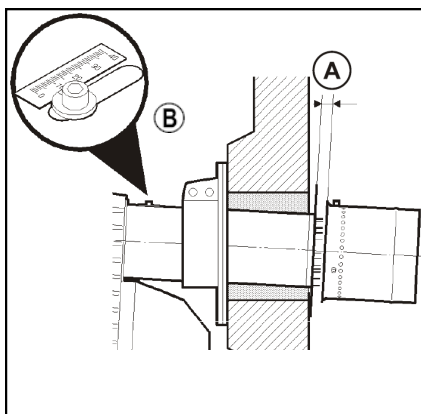

Push bar adjustment

- i** With the servomotor recirculation port at the zero position, the push bar is factory set at scale value 5 on scale (B). If correction is required, proceed as follows:
- ❶ Separate the spherical head of the push bar from the servomotor shaft.
 - ❷ Screw or unscrew the spherical head.
 - i** One rotation corresponds to approximately 0.8 scale values.
 - ❸ Reattach the spherical head to the servomotor shaft.

Flame tube mounting

- ❶ Separate the spherical head of the push bar from the servomotor shaft.
- ❷ Slide the push bar forward and turn retaining bolts outward.
- ❸ Mount the flame tube on the retaining bolts.
- ❹ Reattach the spherical head of the push bar and check the width of the gap.

- i** For homogeneous recirculation and optimal flame stability on start-up: 5 mm gap width over the entire circumference (A) of the flame tube.
- ❺ If necessary, dismantle the flame tube again and adjust the recirculation gap by screwing or unscrewing the retaining bolts to the corresponding position.
 - i** One rotation of the retaining bolts corresponds to a displacement of 0.8mm.

Assembly

Oil nozzle selection and installation Ignition electrodes inspection

Oil nozzle selection

The best combustion results are generally achieved with a Delavan 80°A or Danfoss 80°S type nozzle. Determine the nozzle size corresponding to the burner output desired, using the settings table on page 19.

Installing the heating oil nozzle

- 1 Extract (A) the insert (click closure).
- 2 Remove the cap.
- 3 Screw in the nozzle.
- 4 Latch the (A) insert on to the burner head.

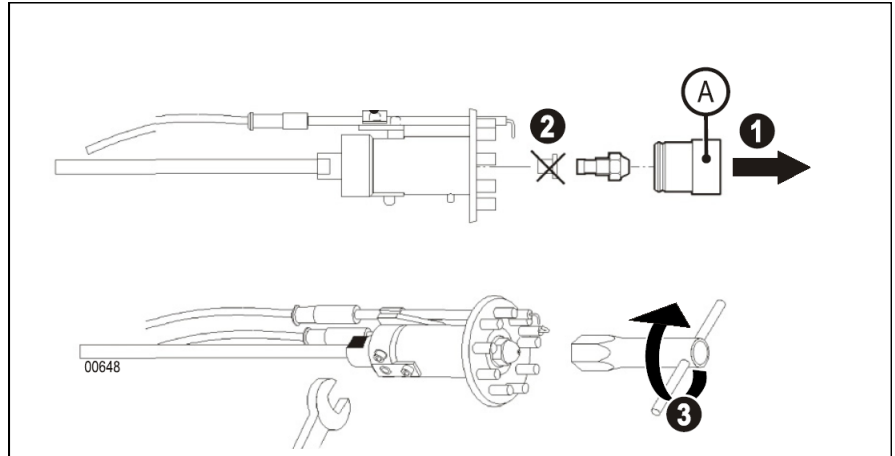

Inspecting the ignition electrode position

	Dimension (mm)			
	C	D	E	F
VB30.120D VB30.190D /230D	2	9	18	5

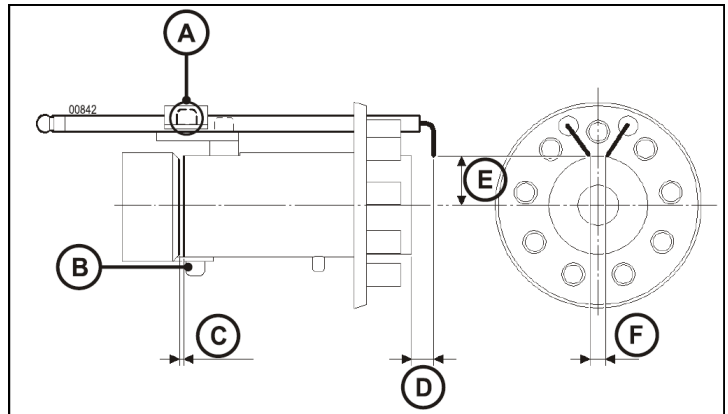

	Dimension (mm)			
	C	D	E	F
VB35.320D VB35.370D	3	23	28	6

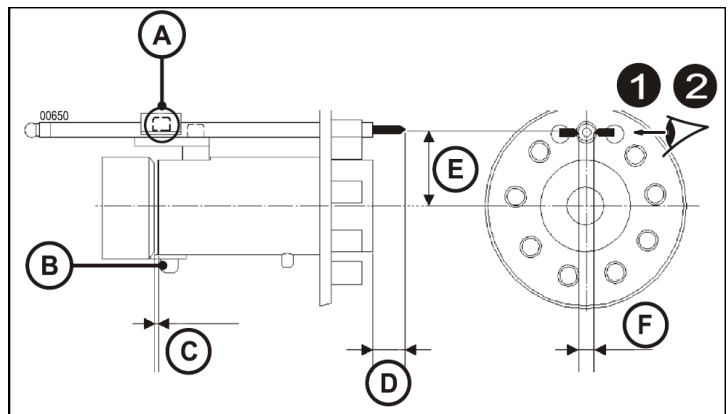

- 1 Check the dimensions indicated in the above drawing.
- 2 To change the position of the ignition electrodes, loosen locking screw (A).
- 3 Align the ignition electrodes with the nozzle opening axle (only for VB35.320D / 370D).
- 4 Wrap the ignition cables around the nozzle linkage.
Connect the ignition electrodes cable.
- i To avoid problems with flame monitoring, ensure that the flame monitor is not covered.
- 5 Check dimensions (C). Adjust the value using screw (B) if necessary.
- i This electrode position allows to optimize the burner starts.

Assembly

Equipment panel installation Nozzle position adjustment

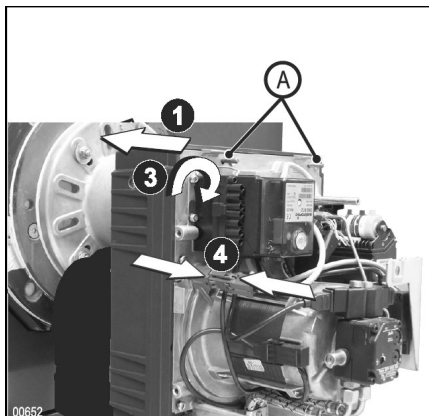

Equipment panel installation

- ⚠ Apply high temperature grease to the outer rim of the nozzle plate.
- ❶ Carefully insert the nozzle linkage into the flame tube.
- ❷ Attach the burner equipment plate on to the housing.
- ❸ Tighten the 5 quick-locking screws ❶.
- ❹ Connect the red plug for the recirculation gap servomotor.

ⓘ The two bolts located on the housing are provided as a guide for positioning the equipment panel.

Nozzle position adjustment

- ❶ Check dimensions. Adjust the value using screw ❷ if necessary.

ⓘ Check and correct the nozzle position, each time it is replaced.

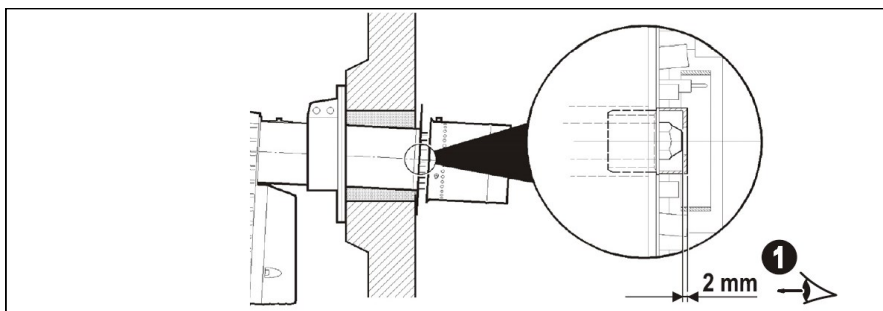

VB30.120D
VB30.190D
VB30.230D

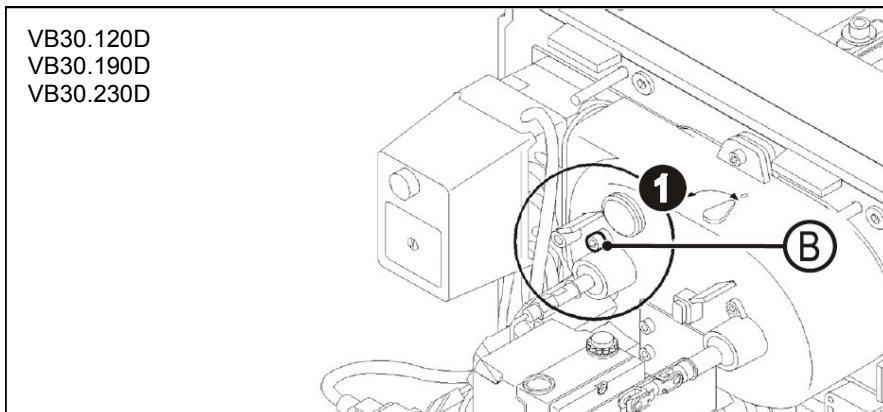

VB35.320D
VB35.370D

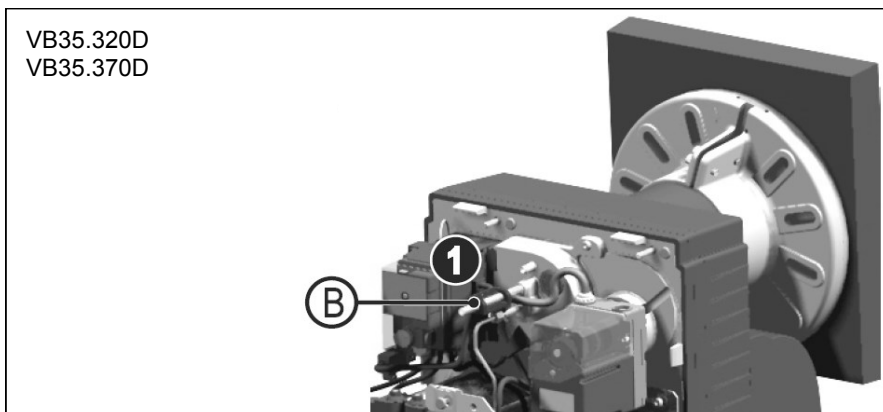

Assembly

Acoustic optimisation (for VB 35.320D / 370D only)

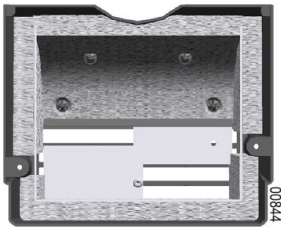
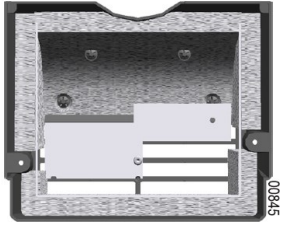
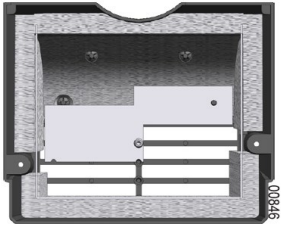
Burner	Maximum output (kW)	Position (cover)	Noise level reduction*
VB35.320D	190		1,8 dBA
VB35.370D	220		2,1 dBA
VB35.320D	250		1,4 dBA
VB35.370D	320		1,5 dBA
VB35.320D	330	Factory setting 	0,7 dBA
VB35.370D	370		1,0 dBA

* Noise level without baffle plates according to "Technical specifications" table entry

Commissioning

Oil and electrical connections

Recommendations for combustion efficiency measurement Guidelines for recirculation gap adjustment

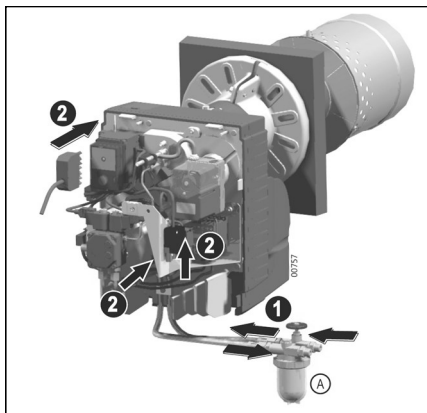

Oil and electrical connections

⚠ For safety reasons we recommend that you do not connect the oil or power supplies prior to commissioning.

- 1** Connect the burner oil hoses to the oil supply.
- 2** Connect the electrical plugs.
- A** Oil filter

Recommendations for combustion efficiency measurement

i Carefully adjust the burner, so that it meets locally applicable emission regulations.

The flue gas circuit between the chimney and the boiler flue outlet must be tightly sealed to prevent measurement errors.

To carry out combustion measurements, adhere to burner running time:

- 5 min. operation (boiler heated)
- 10 min. operation (boiler cold).

When burner installation and adjustment is complete:

- Check soot index.
- Check smoke emissions values.

⚠ In order to avoid flame monitoring problems at low power, adhere to the recommended settings

Guidelines for recirculation gap adjustment (during operation)

⚠ The proportion of recirculation gas depends on the recirculation gap. This exerts a direct influence on the NO_x level. If the recirculation gap is large, the NO_x content is low. As a result, however, flame stability deteriorates. The recirculation gap must be adjusted, so that it achieves the lowest possible NO_x levels, with a stable flame.

Adjusting the recirculation gap via the "recirculation gap" servomotor vents:

If the recirculation gap is too small:

- Increase vent II value.
- Check combustion.

If the recirculation gap is too large:

- Switch burner off.
- Decrease vent II value.
- Start the burner.
- Check combustion.

⚠ Adjust vent III to between I and II.

Commissioning

Recommended settings

Recommended setting for condensing boilers with increased combustion chamber back pressure (eg STRATON)

Burner	Burner output ⁽¹⁾	Nozzle Danfoss 80°S ⁽²⁾ Delavan 80°A ⁽³⁾	Oil pressure ⁽¹⁾	Servo- motor Air regula- tion ^{(1)*}	Servo- motor Recirculation gap ^{(1)**}	Display Air damper position	Recirculation gap Start/operation	Air pres- sure at burner head ⁽¹⁾	Combust- ion chamber pressure	Value CO ₂ ⁽¹⁾
	[kW]	[GPH]	[bar]	(ST1/ST2)	(I/II)	Scale	[mm]	[mbar]	[mbar]	[%]
VB30.120D STRATON L 108	80 / 110	1,65 ⁽²⁾	14 / 23	24 / 35	0 / 45°	-	3 / 4	6,4 / 10,9	0,5/0,9	13/13
VB30.190D STRATON XL 150	100 / 140	2,50 ⁽³⁾	10 / 19	22 / 35	0 / 90°	12 / 20	5 / 13	6,7 / 10	1,0/1,9	12/13
	120 / 150	2,75 ⁽³⁾	11 / 20	30 / 50	0 / 90°	17 / 27	5 / 13	8,8 / 12,7	1,4/2,4	
VB30.230D STRATON XL 210	140 / 195	3,00 ⁽³⁾	11 / 22	30 / 55	0 / 90°	15 / 30	5 / 13	6,1 / 10,0	1,0/2,0	
	150 / 210	3,25 ⁽³⁾	11 / 22	35 / 100	0 / 90°	18 / 55	5 / 13	6,8 / 12,1	1,3/2,6	
VB35.320D STRATON XL 210	160 / 225	3,50 ⁽³⁾	12 / 22	52 / 60	0 / 80°	-	5 / 13	7,8 / 12,2	1,6/2,8	
	175 / 250	4,00 ⁽³⁾	11 / 22	58 / 70	0 / 80°	-	5 / 13	8,6 / 14,9	1,8/3,7	
VB35.370D STRATON XL 350	185 / 280	4,50 ⁽³⁾	10 / 22	48 / 60	0 / 80°	-	5 / 15	7,6 / 14,2	1,8/3,7	

i ⁽¹⁾ Stage 1 / Stage 2

* Adjust the MV vent between ST1 and ST2 (5° below ST2).

** Adjust vent III to between I and II (5° below II).

Recommended settings for low-temperature boilers with chimney draft

Burner	Burner output ⁽¹⁾	Delavan nozzle 80°A	Oil pressure ⁽¹⁾	Air regulation servomotor ^{(1)*}	Recirculation gap servomotor ^{(1)**}	Display Air damper position	Recirculation gap Start/operation	Burner head air pressure ⁽¹⁾	CO ₂ value ⁽¹⁾
	[kW]	[GPH]	[bar]	(ST1/ST2)	(I/II)	Scale	[mm]	[mbar]	[%]
VB30.120D	55 / 80	1,25	8 / 23,5	18 / 31	0 / 72°	8 / 15	5 / 10	2,8 / 6,6	12/13
	80 / 105	1,75	10 / 17	30 / 90	0 / 72°	14,5 / 50	5 / 10	6,5 / 11,2	
VB30.190D	80 / 120	1,75	10 / 23	20 / 28	0 / 90°	9 / 13	5 / 13	1,8 / 5,7	
	110 / 170	3,00	9,5 / 19	30 / 90	0 / 90°	14 / 50	5 / 13	5,7 / 15,5	
VB30.230D	130 / 185	2,75	11 / 23,5	28 / 50	0 / 90°	13 / 25	5 / 13	5,0 / 10,0	
	150 / 195	3,00	11,5 / 21,5	32 / 60	0 / 90°	16 / 32	5 / 13	7,0 / 11,5	
	170 / 220	4,00	9 / 18	40 / 80	0 / 90°	20 / 40	5 / 13	8,0 / 12,5	
VB35.320D	150 / 220	3,00	10 / 22	38 / 45	0 / 80°	-	5 / 13	5,0 / 10,3	
	180 / 250	4,00	11 / 21,5	40 / 48	0 / 80°	-	5 / 13	6,2 / 11,6	
	220 / 324	5,00	12 / 24	49 / 110	0 / 80°	-	5 / 13	9,6 / 19,7	
VB35.370D	165 / 250	4,00	10 / 23	38 / 50	0 / 70°	-	5 / 10	5,3 / 11,9	
	185 / 280	4,50	10 / 22,5	48 / 60	0 / 90°	-	5 / 15	7,6 / 14,2	
	210 / 320	5,00	10 / 22,5	50 / 77	0 / 90°	-	5 / 15	8,9 / 16,5	
	240 / 350	5,50	11 / 23	60 / 105	0 / 90°	-	5 / 15	12 / 18,1	

i Grey fields: Factory setting

⁽¹⁾ Stage 1 / Stage 2

* Adjust the MV vent between ST1 and ST2 (5° below ST2).

** Adjust vent III to between I and II (5° below II).

Commissioning

Burner adjustment

Adjusting the burner

- 1 Attach a manometer and vacuum gauge to the oil pump.
- 2 Adjust vent ST0 = 0 ° (for VB35.320D / 370D only).
- 3 Adjust vents ST1 and ST2 for desired output. Vent MV must be adjusted to between ST1 and ST2 (5° below ST2).
- 4 Adjust recirculation gap servomotor vents "I" and "II". Vent "III" must be adjusted to between "I" and "II".
- 5 Only for IRD 1010: Adjust flame monitoring sensitivity to maximum (position 7).
- 6 Start the burner.
- 7 Check pressure at head (stage 2).
- 8 Adjust oil pump pressure (stage 2).
- 9 Adjust the CO2 value for full load using vent ST2.
- 10 Drive the servomotor back and forth, to initialise vent ST2 position.
- 11 Adjust oil pump pressure (stage 1).
- 12 Check pressure at head (stage 1).
- 13 Adjust the CO2 value for part load using vent ST1.
- 14 Drive the servomotor back and forth, to initialise vent ST1 position.
- 15 Measure combustion values and check flame stability.
- 16 Only for IRD 1010: Rotate the flame monitoring potentiometer until LED 1 blinks. Turn back 2 graduations, so that the 2 LEDs illuminate. If LED 1 does not flash, turn potentiometer to position 5.
- 17 Check burner start-up and part load/full load switching. Adjust vent MV (if necessary).
- 18 Copy the following settings into the "checklist" table of the operating manual.

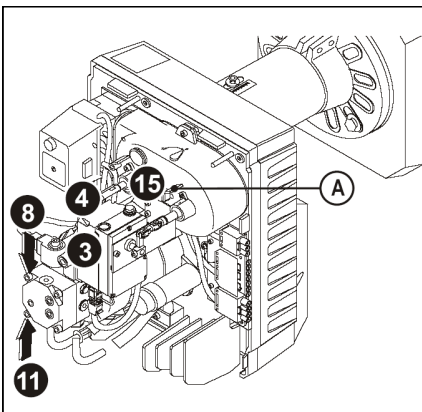

VECTRON B 30.120 DUO
VECTRON B 30.190 / 230 DUO

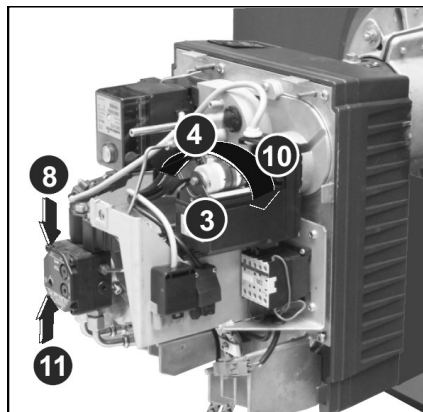

VECTRON B 35.320 DUO
VECTRON B 35.370 DUO

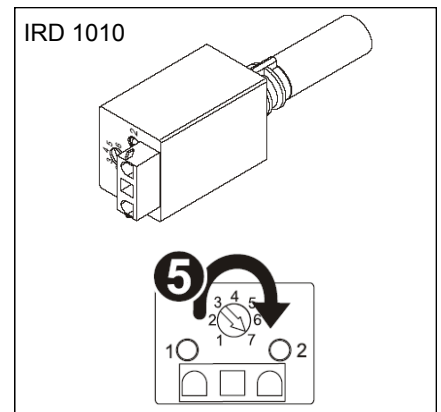

KLC 2002

LED	
Off	Not active
Flashes	Security test / no flame
On	Flame

Maintenance

Operating controls Final inspection Maintenance operation

Operating controls

During commissioning or after burner inspection, the following checks are to be performed:

Remove flame monitor, cover it, and start the burner.	➔	When the safety delay has elapsed, the automatic burner control must switch to fault. The burner switches off.
The burner is in operation: The flame monitor must be removed and covered.	➔	Start again. When the safety delay has elapsed, the automatic burner control must switch to fault.
Remove flame monitor, Expose to daylight, and start the burner.	➔	The automatic burner control must switch to fault after approximately 20 seconds of pre-aeration. The burner switches off.

Final inspection

Start the burner several times and monitor the automatic burner control program execution.
Before the installer leaves the system, he must:

- Make sure that the boiler devices and the thermostats are working properly;
- Make sure that the thermostats are correctly adjusted;
- Check that the fresh air supply opening meets applicable standards;
- Fill in the check sheet on the reverse of the instruction manual;
- Record his name and service number on the instruction manual;
- Refer the operator to the instruction manual enclosed with this document, drawing his attention in particular to the "burner fault" paragraph;
- Hand over the instruction manual to the operator, and advise that the instructions are to be kept in the vicinity of the burner.

Maintenance operation

The burner and boiler must be inspected and cleaned at least once a year.
Only qualified professional installers may carry out these works.

 **A significant flue gas temperature increase means that the boiler is dirty and must be cleaned.**

1. Turn off the heating system master switch and disconnect the burner from the power supply.
2. Check the condition of the combustion chamber and exhaust gas routing. Clean if necessary.
3. Move the burner into the service position.
4. Check and clean the oil filter. Replace if necessary. Check the condition of the nozzle. Check the condition of the electrodes (replace annually if necessary). Check the fresh air inlet to the boiler room and clean.
5. Clean all burner elements (for suitable flame head cleaning agents, see spare parts list).
6. Replace faulty parts.
7. Move the burner into the operating position.
8. Mount the manometer and vacuum gauge to the burner pump.
9. Check the electrical connections of the burner. Turn on the system master switch.
10. Start the burner. Adjust burner.
11. Carry out combustion measurements (boiler in operation).
12. Enter the measurement results and the material replaced on the check sheet, located on the reverse of the instruction manual.
13. Carry out a functional final inspection and a final inspection.

Maintenance

Operating faults

Before undertaking any intervention, the installer must carry out the following checks:

- Is there power to the boiler and burner (light displays on, safety thermostat switched on)?
- Is the oil supply ensured?
- Does the controller or the boiler thermostat indicate heat demand (generate demand)?
- Does the condition of the flue gas system allow for good combustion (date last cleaned)?

Fault	Probable causes	Solution
The burner will not start.	× No power supply.	→ Put the safety thermostat back into operation. → Check fuses and switches. → Increase the set point of the thermostats or controller (adjust to higher than the boiler temperature).
Motor will not start.	× Faulty motor.	→ Replace the motor.
	× Heat protection relay tripped	→ Reset
	× Faulty condenser.	→ Replace the condenser
Mechanical noise.	× Damaged motor bearings.	→ Replace the motor.
	× Fan wheel rubbing.	→ Check positioning.
No ignition spark.	× Short circuit in ignition electrodes.	→ Correct ignition electrodes clearance.
	× Ignition electrodes too far apart.	→ Correct ignition electrodes clearance.
	× Dirty, wet electrodes. × Electrodes cable not properly connected.	→ Clean or replace ignition electrodes. → Check connections.
	× Defective ignition electrodes insulation.	→ Replace electrodes.
	× Defective ignition electrodes cable.	→ Replace ignition cable.
	× Defective transformer.	→ Replace transformer.
The burner switches to fault.	× Dirty flame monitor.	→ Clean cell.
	× Flame monitor adjusted incorrectly × Defective air pressure monitor.	→ Adjust cell → Replace.
	× Flame decreases.	→ Correct burner adjustment.
	× Flame monitor or cable defective.	→ Replace cell or cable.
Pump draws no oil.	× Damaged motor-pump coupling.	→ Replace coupling.
	× Unsealed suction filters, piping or pump hood. × Oil inlet/outlet wrong way round.	→ Replace suction filter. → Tighten connections or hood. → Reverse connections.
	× Shutoff valves closed.	→ Open valves.
	× Clogged filter or tank suction filter.	→ Replace filter or suction filter.
Noises in the pump.	× The pump sucks in air.	→ Check suction line seal.
	× Pump runs empty.	→ Clean filter, check suction line if necessary. Check the oil supply line configuration; there must be no constriction or pinching of the tubes, and the heating oil must not be too cold.
Wrong combustion values.	× Wrong adjustment.	→ Check burner adjustment.
	× No air.	→ Correct air flow.
	× Dirty or worn nozzle.	→ Replace nozzle.
	× No atomisation.	→ Connect solenoid valve. Replace nozzle. Replace pump.
	× Dirty combustion head	→ Clean combustion head
	× Suction lines dirty.	→ Clean.
	× Insufficiently ventilated boiler room.	→ Improve ventilation.

Maintenance

Automatic burner controller displays

Normal burner operation: The code is sent every 5 seconds. In between, the LED is off.

• —	Idle, no heat demand
• — —	Error in power supply (frequency or voltage)
• •	Waiting for oil preheater contact or air pressure monitor opening or air damper position open
• • •	Burner start-up
•	Burner in operation (after safety delay elapsed)
• • — —	Burner switches off
— — — — —	Caution: Machine safe life about to be exceeded

Burner fault: The code is sent every 10 seconds. In between, the LED is permanently on.

— •	Extraneous light
• —	No flame after safety delay elapsed
• • —	Flame failure during operation
— • •	Extraneous light after burner stop
— • • •	Two flame sensors connected
• — —	Air pressure monitor opens during operation
— — •	Air pressure monitor does not close
• — — —	Air pressure monitor not in idle position
• • — —	Oil preheater temperature not reached
— — • •	Oil preheater temperature shortfall during burner operation
— — — —	Burner manually locked
• • • •	Unknown error code
— — — — —	Machine safe life exceeded
X X X X X X	Device error

Blink signal:

- long (0.5s)
- short (0.1s)
- X undefined

Circuit diagram

VB30.120/190/230D

A10	Automatic burner controller	SQ2	Recirculation gap servomotor
B1	Flame monitoring	T11	Ignition transformer
EV	Remote unlock button	X1	Boiler connection (7-pin)
H1	Burner fault	X2	Boiler connection (4-pin)
M1	Blower motor	X3	Water conservation valve connection (3-pin)
P1	Elapsed time meter stage 1	X6	Recirculation gap connection (6-pin)
P2	Elapsed time meter stage 2	X7	Remote unlock connection (2-pin)
STB	Safety temperature limiter	X8	Flame monitor connection (3-pin)
ST11	Control thermostat (stage 1)	Y0	Water conservation valve
ST12	Control thermostat (stage 2)	Y1	Solenoid valve stage 1
SQ1	Air regulation servomotor	Y2	Solenoid valve stage 2

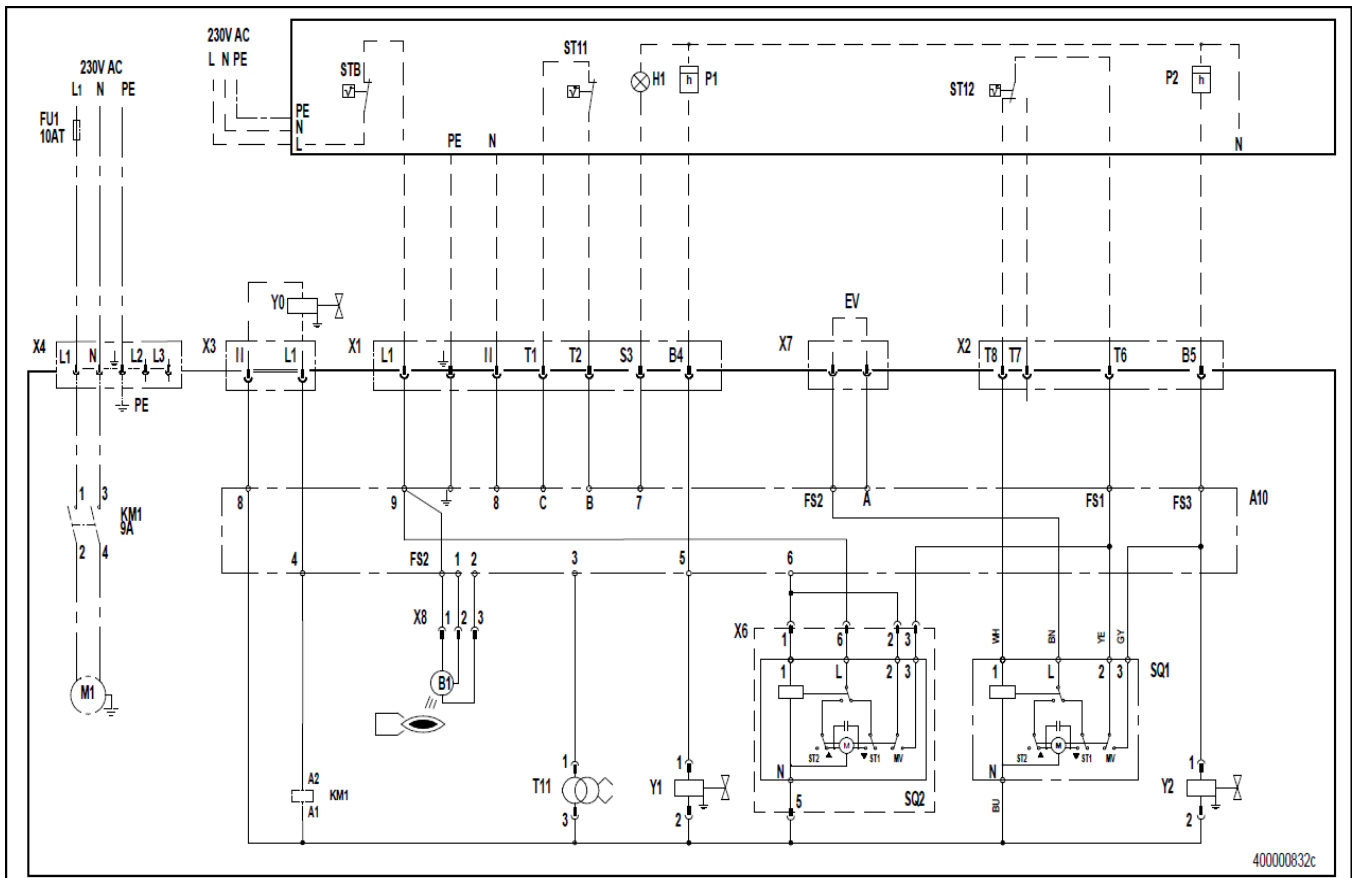

Circuit diagram

VB35.320/370D

A10	Automatic burner controller	T11	Ignition transformer
B1	Flame monitoring	X1	Boiler connection (7-pin)
EV	Remote unlock button	X2	Boiler connection (4-pin)
H1	Burner fault	X3	Water conservation valve connection (3-pin)
KM1	Motor contactor	X4	Separate blower motor power supply (5-pin)
M1	Blower motor	X5	Motor contactor connection (2-pin)
P1	Elapsed time meter stage 1	X6	Recirculation gap connection (6-pin)
P2	Elapsed time meter stage 2	X7	Remote unlock connection (2-pin)
STB	Safety temperature limiter	X8	Flame monitor connection (3-pin)
ST11	Control thermostat (stage 1)	Y0	Water conservation valve
ST12	Control thermostat (stage 2)	Y1	Solenoid valve stage 1
SQ1	Air regulation servomotor	Y2	Solenoid valve stage 2
SQ2	Recirculation gap servomotor		

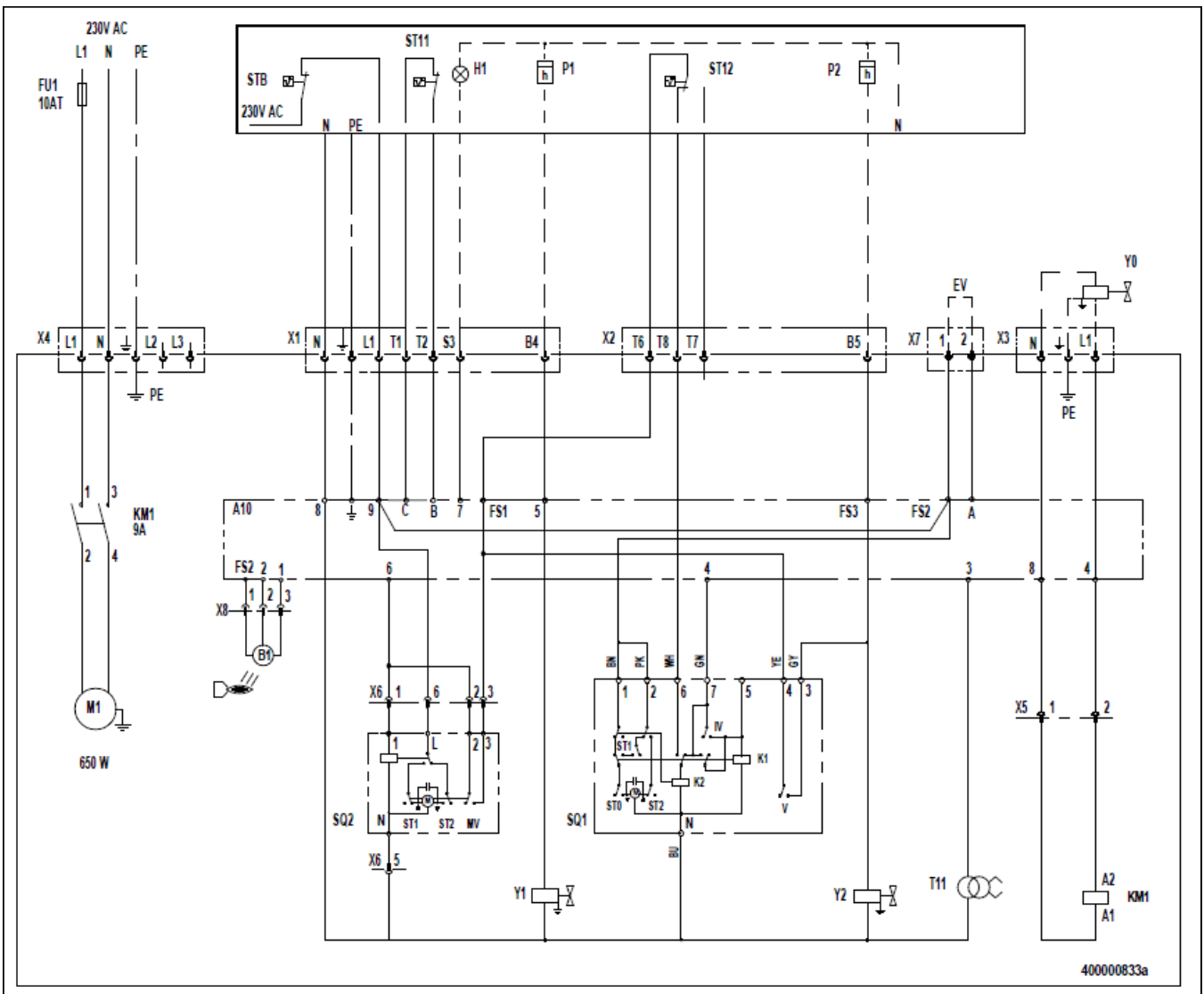

elco

Service: